

CC
CD

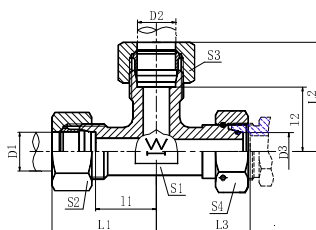

CC-RNW
CD-RNW

METRIC MALE 24° CONE/METRIC FEMALE 24° CONE
RUN TEE

REF. ISO 8434-1

PART NO.		THREAD		TUBE O.D.		O-RING	DIMENSIONS					
BODY	ASSEMBLY	E,F	G	D1,D2	D3		I1,I2	L1,L2	L3	S1	S2,S3	S4
L SERIES												
CC-12Z	CC-12RNWZ	M12X1.5	M12X1.5	6	6	O04.5x1.5	12	27	26	12	14	14
CC-14Z	CC-14RNWZ	M14X1.5	M14X1.5	8	8	O06.5x1.5	14	29	27.5	12	17	17
CC-16Z	CC-16RNWZ	M16X1.5	M16X1.5	10	10	O08.0x1.5	15	30	29	14	19	19
CC-18Z	CC-18RNWZ	M18X1.5	M18X1.5	12	12	O10.0x1.5	17	32	29.5	17	22	22
CC-22Z	CC-22RNWZ	M22X1.5	M22X1.5	15	15	O12.0x2.0	21	36	32.5	19	27	27
CC-26Z	CC-26RNWZ	M26X1.5	M26X1.5	18	18	O15.0x2.0	23.5	40	35.5	24	32	32
CC-30Z	CC-30RNWZ	M30X2	M30X2	22	22	O20.0x2.0	27.5	44	38.5	27	36	36
CC-36Z	CC-36RNWZ	M36X2	M36X2	28	28	O26.0x2.0	30.5	47	41.5	36	41	41
CC-45Z	CC-45RNWZ	M45X2	M45X2	35	35	O32.0x2.5	34.5	56	51	41	50	50
CC-52Z	CC-52RNWZ	M52X2	M52X2	42	42	O38.0x2.5	40	63	56	50	60	60
S SERIES												
CD-14Z	CD-14RNWZ	M14X1.5	M14X1.5	6	6	O04.5x1.5	16	31	27	12	17	17
CD-16Z	CD-16RNWZ	M16X1.5	M16X1.5	8	8	O06.5x1.5	17	32	27.5	14	19	19
CD-18Z	CD-18RNWZ	M18X1.5	M18X1.5	10	10	O08.0x1.5	17.5	34	30	17	22	22
CD-20Z	CD-20RNWZ	M20X1.5	M20X1.5	12	12	O10.0x1.5	21.5	38	31	17	24	24
CD-22Z	CD-22RNWZ	M22X1.5	M22X1.5	14	14	O11.0x2.0	22	40	35	19	27	27
CD-24Z	CD-24RNWZ	M24X1.5	M24X1.5	16	16	O13.0x2.0	24.5	43	36.5	24	30	30
CD-30Z	CD-30RNWZ	M30X2	M30X2	20	20	O16.3x2.4	26.5	48	44.5	27	36	36
CD-36Z	CD-36RNWZ	M36X2	M36X2	25	25	O20.3x2.4	30	54	50	36	46	46
CD-42Z	CD-42RNWZ	M42X2	M42X2	30	30	O25.3x2.4	35.5	62	55	41	50	50
CD-52Z	CD-52RNWZ	M52X2	M52X2	38	38	O33.3x2.4	41	72	63	50	60	60

1. Material options for connector body, nut and the O-ring.

Connector body and nut material	O-ring material	Part. No. suffix	Part No. example
Carbon steel (Default)	NBR	Z	CC-18Z
304 stainless steel	Viton	SR	CC-18SR
316L stainless steel	Viton	SV	CC-18SV
316Ti stainless steel	Viton	SY	CC-18SY

2. Plating options and performance for carbon steel connectors.

Plating method	Part. No. suffix	Part No. example	White rust (Hours)	Red rust (Hours)
Cr3+ plating (Default)	Z	CC-18Z	96	360
Durakote plating	ZD	CC-18ZD	360	720
Zinc-nickel plating	ZN	CC-18ZN	1000	-