

1J

JIC MALE 74° CONE

REF. ISO 8434-2

PART NO.	THREAD		DIMENSIONS							
	E	F			A	B	L	S1		
1J-02Z	5/16"X24	5/16"X24			11.4	11.4	29	12		
1J-02-03Z	5/16"X24	3/8"X24			11.4	12.2	29.5	12		
1J-03Z	3/8"X24	3/8"X24			12.2	12.2	30.5	12		
1J-04Z	7/16"X20	7/16"X20			14	14	35	12		
1J-04-05Z	7/16"X20	1/2"X20			14	14	35	14		
1J-04-06Z	7/16"X20	9/16"X18			14	14.1	35.9	17		
1J-04-08Z	7/16"X20	3/4"X16			14	16.7	38.5	22		
1J-05Z	1/2"X20	1/2"X20			14	14	35	14		
1J-05-06Z	1/2"X20	9/16"X18			14	14.1	35.9	17		
1J-05-08Z	1/2"X20	3/4"X16			14	16.7	38.3	22		
1J-05-10Z	1/2"X20	7/8"X14			14	19.3	42.7	24		
1J-06Z	9/16"X18	9/16"X18			14.1	14.1	36	17		
1J-06-08Z	9/16"X18	3/4"X16			14.1	16.7	38.4	22		
1J-06-10Z	9/16"X18	7/8"X14			14.1	19.3	42.8	24		
1J-06-12Z	9/16"X18	1.1/16"X12			14.1	21.9	47.2	30		
1J-08Z	3/4"X16	3/4"X16			16.7	16.7	41	22		
1J-08-10Z	3/4"X16	7/8"X14			16.7	19.3	44	24		
1J-08-12Z	3/4"X16	1.1/16"X12			16.7	21.9	49.8	30		
1J-08-16Z	3/4"X16	1.5/16"X12			16.7	23.1	51	36		
1J-10Z	7/8"X14	7/8"X14			19.3	19.3	48	24		
1J-10-12Z	7/8"X14	1.1/16"X12			19.3	21.9	51	30		
1J-10-16Z	7/8"X14	1.5/16"X12			19.3	23.1	53.2	36		
1J-12Z	1.1/16"X12	1.1/16"X12			21.9	21.9	55	30		
1J-12-14Z	1.1/16"X12	1.3/16"X12			21.9	22.6	55.5	32		
1J-12-16Z	1.1/16"X12	1.5/16"X12			21.9	23.1	55.8	36		
1J-14Z	1.3/16"X12	1.3/16"X12			22.6	22.6	56.1	32		
1J-14-16Z	1.3/16"X12	1.5/16"X12			22.6	23.1	56.5	36		
1J-16Z	1.5/16"X12	1.5/16"X12			23.1	23.1	57	36		
1J-16-20Z	1.5/16"X12	1.5/8"X12			23.1	24.3	60.3	46		
1J-16-24Z	1.5/16"X12	1.7/8"X12			23.1	27.5	65.5	50		
1J-20Z	1.5/8"X12	1.5/8"X12			24.3	24.3	61.5	46		
1J-20-24Z	1.5/8"X12	1.7/8"X12			24.3	27.5	66.8	50		
1J-20-32Z	1.5/8"X12	2.1/2"X12			24.3	33.9	75	65		
1J-24Z	1.7/8"X12	1.7/8"X12			27.5	27.5	70	50		
1J-24-32Z	1.7/8"X12	2.1/2"X12			27.5	33.9	78.5	65		
1J-32Z	2.1/2"X12	2.1/2"X12			33.9	33.9	86.5	65		

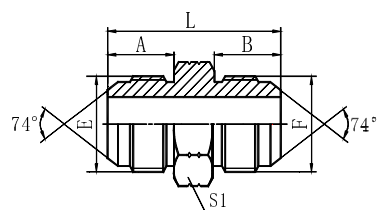

1J

JIC MALE 74° CONE

REF. ISO 8434-2

PART NO.	THREAD		DIMENSIONS							
	E	F			A	B	L	S1		

1. Material options for connector

Connector material	Part. No. suffix	Part No. example
Carbon steel (Default)	Z	1J-08Z
304 stainless steel	SR	1J-08SR
316L stainless steel	SV	1J-08SV
316Ti stainless steel	SY	1J-08SY

2. Plating options and performance for carbon steel connectors.

Plating method	Part. No. suffix	Part No. example	White rust (Hours)	Red rust (Hours)
Cr3+ plating (Default)	Z	1J-08Z	96	360
Durakote plating	ZD	1J-08ZD	360	720
Zinc-nickel plating	ZN	1J-08ZN	1000	-