

1NT

NPT MALE/BSPT MALE

PART NO.	THREAD		DIMENSIONS					
	E	F			A	B	L	S1
1NT-02Z	Z1/8"X27	R1/8"X28			10.5	10	26.5	12
1NT-02-04Z	Z1/8"X27	R1/4"X19			10.5	14.5	31	17
1NT-04Z	Z1/4"X18	R1/4"X19			15	14.5	35	17
1NT-04-02Z	Z1/4"X18	R1/8"X28			15	10	31	17
1NT-04-06Z	Z1/4"X18	R3/8"X19			15	15.5	37	19
1NT-06Z	Z3/8"X18	R3/8"X19			16	15	37	19
1NT-06-04Z	Z3/8"X18	R1/4"X19			16	14.5	36.5	19
1NT-06-08Z	Z3/8"X18	R1/2"X14			15	20	42	22
1NT-08Z	Z1/2"X14	R1/2"X14			19.5	20	47.5	22
1NT-08-06Z	Z1/2"X14	R3/8"X19			19.5	15	42.5	22
1NT-08-12Z	Z1/2"X14	R3/4"X14			19.5	20	49.5	27
1NT-12Z	Z3/4"X14	R3/4"X14			19.5	20	49.5	27
1NT-12-08Z	Z3/4"X14	R1/2"X14			19.5	20	49.5	27
1NT-12-16Z	Z3/4"X14	R1"X11			19.5	25.5	56	36
1NT-16Z	Z1"X11.5	R1"X11			24.3	25.5	62	36
1NT-16-12Z	Z1"X11.5	R3/4"X14			24.6	20	56.8	36
1NT-16-20Z	Z1"X11.5	R1.1/4"X11			25.5	26.5	65	46
1NT-20Z	Z1.1/4"X11.5	R1.1/4"X11			26.5	26.5	66	46
1NT-20-16Z	Z1.1/4"X11.5	R1"X11			26.5	25.5	64	46
1NT-20-24Z	Z1.1/4"X11.5	R1.1/2"X11			26.5	26.5	68	50
1NT-24Z	Z1.1/2"X11.5	R1.1/2"X11			27.5	26.5	69	50
1NT-24-32Z	Z1.1/2"X11.5	R2"X11			27.5	30	74.5	65
1NT-32Z	Z2"X11.5	R2"X11			27.5	30	74.5	65

1. Material options for connector.

Connector material	Part. No. suffix	Part No. example
Carbon steel (Default)	Z	1NT-12Z
304 stainless steel	SR	1NT-12SR
316L stainless steel	SV	1NT-12SV
316Ti stainless steel	SY	1NT-12SY

2. Plating options and performance for carbon steel connectors.

Plating method	Part. No. suffix	Part No. example	White rust (Hours)	Red rust(Hours)
Cr3+ plating (Default)	Z	1NT-12Z	96	360

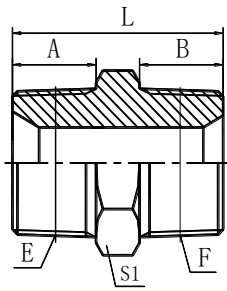

1NT

NPT MALE/BSPT MALE

PART NO.	THREAD		DIMENSIONS					
	E	F			A	B	L	S1
Durakote plating	ZD	1NT-12ZD			360		720	
Zinc-nickel plating	ZN	1NT-12ZN			1000		-	