

**2B**

BSP MALE DOUBLE USE FOR 60° CONE SEAT OR BONDED SEAL / BSP FEMALE 60° CONE

PART NO.	THREAD		DIMENSIONS						
	E	F			A	B	L	S1	S2
2B-02Z	G1/8"X28	G1/8"X28			10	5.5	25	14	14
2B-02-04Z	G1/8"X28	G1/4"X19			10	5.5	27	14	19
2B-04Z	G1/4"X19	G1/4"X19			12	5.5	29	19	19
2B-04-06Z	G1/4"X19	G3/8"X19			12	6.3	30.5	19	22
2B-04-08Z	G1/4"X19	G1/2"X14			12	7.5	32	19	27
2B-06Z	G3/8"X19	G3/8"X19			13.5	6.3	34	22	22
2B-06-08Z	G3/8"X19	G1/2"X14			13.5	7.5	35.5	22	27
2B-06-10Z	G3/8"X19	G5/8"X14			13.5	9.5	36	22	30
2B-08Z	G1/2"X14	G1/2"X14			16	7.5	40	27	27
2B-08-06Z	G1/2"X14	G3/8"X19			16	6.3	38.2	27	22
2B-08-12Z	G1/2"X14	G3/4"X14			16	10.9	41	27	32
2B-10Z	G5/8"X14	G5/8"X14			17.5	9.5	42	30	30
2B-10-08Z	G5/8"X14	G1/2"X14			18	7.5	41.5	30	27
2B-10-12Z	G5/8"X14	G3/4"X14			17.5	10.9	42.5	30	32
2B-12Z	G3/4"X14	G3/4"X14			18.5	10.9	44.5	32	32
2B-12-10Z	G3/4"X14	G5/8"X14			18.5	9.5	44	32	30
2B-12-16Z	G3/4"X14	G1"X11			18.5	11.7	46	32	41
2B-16Z	G1"X11	G1"X11			20.5	11.7	50	41	41
2B-16-12Z	G1"X11	G3/4"X14			20.5	10.9	48	41	32
2B-16-20Z	G1"X11	G1.1/4"X11			20.5	10.1	53	41	50
2B-20Z	G1.1/4"X11	G1.1/4"X11			20.5	10.1	55	50	50
2B-20-16Z	G1.1/4"X11	G1"X11			20.5	11.7	52	50	41
2B-20-24Z	G1.1/4"X11	G1.1/2"X11			20.5	12.5	55.5	50	55
2B-24Z	G1.1/2"X11	G1.1/2"X11			23	12.5	58	55	55
2B-32Z	G2"X11	G2"X11			25.5	16.1	63.5	70	70

1. Material options for connector.

Connector material	Part. No. suffix	Part No. example
Carbon steel (Default)	Z	2B-08Z
304 stainless steel	SR	2B-08SR
316L stainless steel	SV	2B-08SV
316Ti stainless steel	SY	2B-08SY

2. Plating options and performance for carbon steel connectors.

Plating method	Part. No. suffix	Part No. example	White rust (Hours)	Red rust(Hours)
----------------	------------------	------------------	--------------------	-----------------

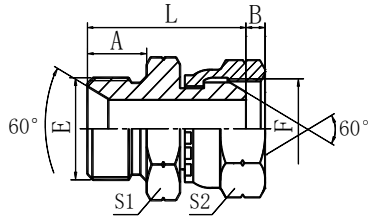

**2B**

BSP MALE DOUBLE USE FOR 60° CONE SEAT OR  
BONDED SEAL / BSP FEMALE 60° CONE

PART NO.	THREAD			DIMENSIONS				
	E	F		A	B	L	S1	S2
Cr3+ plating (Default)		Z	2B-08Z	96		360		
Durakote plating		ZD	2B-08ZD	360		720		
Zinc-nickel plating		ZN	2B-08ZN	1000		-		