

1JN9

JIC MALE 74° CONE / NPT MALE 90° ELBOW

PART NO.	THREAD		DIMENSIONS						
	E	F	A	B	S1				
1JN9-02Z	5/16"X24	Z1/8"X27	21	21	11				
1JN9-03-02Z	3/8"X24	Z1/8"X27	22	21	11				
1JN9-04Z	7/16"X20	Z1/4"X18	25.6	25.5	14				
1JN9-04-02Z	7/16"X20	Z1/8"X27	24.5	21	11				
1JN9-04-06Z	7/16"X20	Z3/8"X18	29.5	31	19				
1JN9-05-02Z	1/2"X20	Z1/8"X27	26.6	23.5	14				
1JN9-05-04Z	1/2"X20	Z1/4"X18	25.6	25.5	14				
1JN9-05-06Z	1/2"X20	Z3/8"X18	29.5	31	19				
1JN9-06Z	9/16"X18	Z3/8"X18	29	31	19				
1JN9-06-04Z	9/16"X18	Z1/4"X18	25.8	25.5	14				
1JN9-06-08Z	9/16"X18	Z1/2"X14	32	36.7	22				
1JN9-08Z	3/4"X16	Z1/2"X14	34.8	37.3	22				
1JN9-08-04Z	3/4"X16	Z1/4"X18	32	28.5	19				
1JN9-08-06Z	3/4"X16	Z3/8"X18	32	31	19				
1JN9-08-12Z	3/4"X16	Z3/4"X14	37.9	44	27				
1JN9-10-06Z	7/8"X14	Z3/8"X18	37.8	32.5	22				
1JN9-10-08Z	7/8"X14	Z1/2"X14	37.8	37.3	22				
1JN9-10-12Z	7/8"X14	Z3/4"X14	41	44	27				
1JN9-10-16Z	7/8"X14	Z1"X11.5	44.5	50	33				
1JN9-12Z	1.1/16"X12	Z3/4"X14	44.2	44	27				
1JN9-12-08Z	1.1/16"X12	Z1/2"X14	44.2	40	27				
1JN9-12-16Z	1.1/16"X12	Z1"X11.5	49	50	33				
1JN9-12-20Z	1.1/16"X12	Z1.1/4"X11.5	52.5	54.5	41				
1JN9-14-12Z	1.3/16"X12	Z3/4"X14	47.5	45	30				
1JN9-14-16Z	1.3/16"X12	Z1"X11.5	48.5	50	33				
1JN9-16Z	1.5/16"X12	Z1"X11.5	49	50	33				
1JN9-16-12Z	1.5/16"X12	Z3/4"X14	49	51	33				
1JN9-16-20Z	1.5/16"X12	Z1.1/4"X11.5	54	60.5	41				
1JN9-16-24Z	1.5/16"X12	Z1.1/2"X11.5	58	63	48				
1JN9-20Z	1.5/8"X12	Z1.1/4"X11.5	55.5	54.5	41				
1JN9-20-16Z	1.5/8"X12	Z1"X11.5	55.5	59.6	41				
1JN9-20-24Z	1.5/8"X12	Z1.1/2"X11.5	59.4	63	48				
1JN9-24Z	1.7/8"X12	Z1.1/2"X11.5	62.5	63	48				
1JN9-24-20Z	1.7/8"X12	Z1.1/4"X11.5	62.5	63	48				
1JN9-32-24Z	2.1/2"X12	Z1.1/2"X11.5	75.4	67.5	63				
1JN9-32Z	2.1/2"X12	Z2"X11.5	75.4	67.5	63				

1. Material options for connector

Connector material	Part. No. suffix	Part No. example
--------------------	------------------	------------------

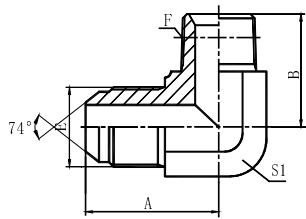

1JN9

JIC MALE 74° CONE / NPT MALE 90° ELBOW

PART NO.	THREAD		DIMENSIONS						
	E	F			A	B	S1		
Carbon steel (Default)			Z						1JN9-08Z
304 stainless steel			SR						1JN9-08SR
316L stainless steel			SV						1JN9-08SV
316Ti stainless steel			SY						1JN9-08SY

2. Plating options and performance for carbon steel connectors.

Plating method	Part. No. suffix	Part No. example	White rust (Hours)	Red rust(Hours)
Cr3+ plating (Default)	Z	1JN9-08Z	96	360
Durakote plating	ZD	1JN9-08ZD	360	720
Zinc-nickel plating	ZN	1JN9-08ZN	1000	-