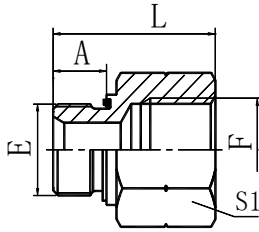
**5B-WD**

BSP MALE CAPTIVE SEAL / BSP FEMALE ISO 1179

PART NO.	THREAD		CAPTIVE SEAL	DIMENSIONS			
	E	F		A	L	S1	
5B-02-04WDZ	G1/8"X28	G1/4"X19	WD-B02	8	30.5	19	
5B-02-06WDZ	G1/8"X28	G3/8"X19	WD-B02	8	32.5	22	
5B-04-02WDZ	G1/4"X19	G 1/8"X28	WD-B04	12	31.5	19	
5B-04WDZ	G1/4"X19	G1/4"X19	WD-B04	12	33.5	19	
5B-04-06WDZ	G1/4"X19	G3/8"X19	WD-B04	12	37	22	
5B-04-08WDZ	G1/4"X19	G1/2"X14	WD-B04	12	43	27	
5B-04-12WDZ	G1/4"X19	G3/4"X14	WD-B04	12	43.5	36	
5B-04-16WD Z	G1/4"X19	G1"X11	WD-B04	12	49	41	
5B-06-02WDZ	G3/8"X19	G1/8"X28	WD-B06	12	30.5	22	
5B-06-04WDZ	G3/8"X19	G1/4"X19	WD-B06	12	37.5	22	
5B-06-08WDZ	G3/8"X19	G1/2"X14	WD-B06	12	43.5	27	
5B-06-12WDZ	G3/8"X19	G3/4"X14	WD-B06	12	44	36	
5B-06WDZ	G3/8"X19	G3/8"X19	WD-B06	12	36.5	22	
5B-08-02WDZ	G1/2"X14	G1/8"X28	WD-B08	14	27	27	
5B-08-04WDZ	G1/2"X14	G1/4"X19	WD-B08	14	38	27	
5B-08-06WDZ	G1/2"X14	G3/8"X19	WD-B08	14	41	27	
5B-08-12WDZ	G1/2"X14	G3/4"X14	WD-B08	14	46	36	
5B-08-16WDZ	G1/2"X14	G1"X11	WD-B08	14	51	41	
5B-08-20WDZ	G1/2"X14	G1.1/4"X11	WD-B08	14	53	50	
5B-08WDZ	G1/2"X14	G1/2"X14	WD-B08	14	45	27	
5B-12-04WDZ	G3/4"X14	G1/4"X19	WD-B12	16	30	32	
5B-12-06WDZ	G3/4"X14	G3/8"X19	WD-B12	16	38	32	
5B-12-08WDZ	G3/4"X14	G1/2"X14	WD-B12	16	47.5	32	
5B-12-16WDZ	G3/4"X14	G1"X11	WD-B12	16	53.5	41	
5B-12-20WDZ	G3/4"X14	G1.1/4"X11	WD-B12	16	54.5	50	
5B-12-24WDZ	G3/4"X14	G1.1/2"X11	WD-B12	16	57	55	
5B-16-04WDZ	G1"X11	G1/4"X19	WD-B16	18	34	41	
5B-16-06WDZ	G1"X11	G3/8"X19	WD-B16	18	45	41	
5B-16-08WDZ	G1"X11	G1/2"X14	WD-B16	18	49.5	41	
5B-16-12WDZ	G1"X11	G3/4"X14	WD-B16	18	50.5	41	
5B-16-20WDZ	G1"X11	G1.1/4"X11	WD-B16	18	56.5	50	
5B-16-24WDZ	G1"X11	G1.1/2"X11	WD-B16	18	59	55	
5B-20-04WDZ	G1.1/4"X11	G1/4"X19	WD-B20	20	36	50	
5B-20-08WDZ	G1.1/4"X11	G1/2"X14	WD-B20	20	51.5	50	
5B-20-12WDZ	G1.1/4"X11	G3/4"X14	WD-B20	20	52.5	50	
5B-20-16WDZ	G1.1/4"X11	G1"X11	WD-B20	20	57.5	50	
5B-20-24WDZ	G1.1/4"X11	G1.1/2"X11	WD-B20	20	59.5	55	
5B-20-32WDZ	G1.1/4"X11	G2"X11	WD-B20	20	64	70	

**5B-WD**

BSP MALE CAPTIVE SEAL / BSP FEMALE ISO 1179

PART NO.	THREAD		CAPTIVE SEAL	DIMENSIONS			
	E	F		A	L	S1	
5B-20WDZ	G1.1/4"X11	G1.1/4"X11	WD-B20	20	58	50	
5B-24-08WDZ	G1.1/2"X11	G1/2"X14	WD-B24	22	40	55	
5B-24-12WDZ	G1.1/2"X11	G3/4"X14	WD-B24	22	54	55	
5B-24-16WDZ	G1.1/2"X11	G1"X11	WD-B24	22	59.5	55	
5B-24-20WDZ	G1.1/2"X11	G1.1/4"X11	WD-B24	22	60	55	
5B-24-32WDZ	G1.1/2"X11	G2"X11	WD-B24	22	66	70	
5B-24WDZ	G1.1/2"X11	G1.1/2"X11	WD-B24	22	59.5	55	
5B-32-12WDZ	G2"X11	G3/4"X14	WD-B32	24	46	75	
5B-32-16WDZ	G2"X11	G1"X11	WD-B32	24	46	75	
5B-32-24WDZ	G2"X11	G1.1/2"X11	WD-B32	24	65	75	

1. Material options for connector body and the Captive seal.

Connector body material	Captive seal material	Part. No. suffix	Part No. example
Carbon steel (Default)	NBR	Z	5B-08WDZ
304 stainless steel	Viton	SR	5B-08WDSR
316L stainless steel	Viton	SV	5B-08WDSV
316Ti stainless steel	Viton	SY	5B-08WDSY

2. Plating options and performance for carbon steel connectors.

Plating method	Part. No. suffix	Part No. example	White rust (Hours)	Red rust(Hours)
Cr3+ plating (Default)	Z	5B-08WDZ	96	360
Durakote plating	ZD	5B-08WDZD	360	720
Zinc-nickel plating	ZN	5B-08WDZN	1000	-