

1T-SP

BSPT MALE

PART NO.	THREAD		DIMENSIONS					
	E	F	A	B	L	S1		
1T-02SPZ	R1/8"X28	R1/8"X28	10	10	26	12		
1T-02-04SPZ	R1/8"X28	R1/4"X19	10	14.5	30.5	14		
1T-02-06SPZ	R1/8"X28	R3/8"X19	10	15	31	17		
1T-04SPZ	R1/4"X19	R1/4"X19	14.5	14.5	34	14		
1T-04-06SPZ	R1/4"X19	R3/8"X19	14.5	15	35	17		
1T-04-08SPZ	R1/4"X19	R1/2"X14	15	20	43	22		
1T-06SPZ	R3/8"X19	R3/8"X19	15	15	36	17		
1T-06-08SPZ	R3/8"X19	R1/2"X14	15	20	43	22		
1T-08SPZ	R1/2"X14	R1/2"X14	20	20	46	22		
1T-08-12SPZ	R1/2"X14	R3/4"X14	20	20	48	27		
1T-12SPZ	R3/4"X14	R3/4"X14	20	20	48	27		
1T-12-16SPZ	R3/4"X14	R1"X11	20	25.5	55.5	36		
1T-16SPZ	R1"X11	R1"X11	25.5	25.5	61	36		
1T-16-20SPZ	R1"X11	R1.1/4"X11	25.5	26.5	64	46		
1T-20SPZ	R1.1/4"X11	R1.1/4"X11	26.5	26.5	65.5	46		
1T-20-24SPZ	R1.1/4"X11	R1.1/2"X11	26.5	26.5	67	50		
1T-24SPZ	R1.1/2"X11	R1.1/2"X11	26.5	26.5	67	50		
1T-24-32SPZ	R1.1/2"X11	R2"X11	26.5	30	71.5	65		
1T-32SPZ	R2"X11	R2"X11	30	30	75	65		

1. Material options for connector.

Connector material	Part. No. suffix	Part No. example
Carbon steel (Default)	Z	1T-12-16SPZ
304 stainless steel	SR	1T-12-16SPSR
316L stainless steel	SV	1T-12-16SPSV
316Ti stainless steel	SY	1T-12-16SPSY

2. Plating options and performance for carbon steel connectors.

Plating method	Part. No. suffix	Part No. example	White rust (Hours)	Red rust(Hours)
Cr3+ plating (Default)	Z	1T-12-16SPZ	96	360
Durakote plating	ZD	1T-12-16SPZD	360	720

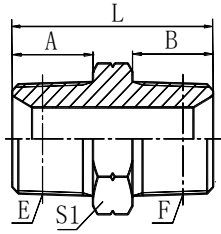

1T-SP

BSPT MALE

PART NO.	THREAD		DIMENSIONS					
	E	F			A	B	L	S1
Zinc-nickel plating	ZN		1T-12-16SPZN		1000		-	