

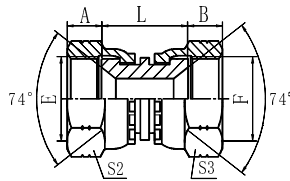

3J



JIC FEMALE 74° SEAT

PART NO.	THREAD		DIMENSIONS						
	E	F	A	B	L	S2	S3		
3J-04Z	7/16"X20	7/16"X20	9	9	19	14	14		
3J-04-05Z	7/16"X20	1/2"X20	9	9.5	20.5	14	17		
3J-04-06Z	7/16"X20	9/16"X18	9	10	20.5	14	19		
3J-05Z	1/2"X20	1/2"X20	9.5	9.5	21	17	17		
3J-05-06Z	1/2"X20	9/16"X18	9.5	10	21	17	19		
3J-06Z	9/16"X18	9/16"X18	10	10	21	19	19		
3J-06-08Z	9/16"X18	3/4"X16	10	11	23	19	22		
3J-08Z	3/4"X16	3/4"X16	11	11	26	22	22		
3J-08-10Z	3/4"X16	7/8"X14	11	13	26.5	22	27		
3J-08-12Z	3/4"X16	1.1/16"X12	11	14.5	28	22	32		
3J-10Z	7/8"X14	7/8"X14	13	13	27	27	27		
3J-10-12Z	7/8"X14	1.1/16"X12	13	14.5	28	27	32		
3J-12Z	1.1/16"X12	1.1/16"X12	14.5	14.5	29	32	32		
3J-12-14Z	1.1/16"X12	1.3/16"X12	14.5	15	29	32	36		
3J-12-16Z	1.1/16"X12	1.5/16"X12	14.5	15.18	29	32	41		
3J-16Z	1.5/16"X12	1.5/16"X12	15.18	15.18	29	41	41		
3J-20Z	1.5/8"X12	1.5/8"X12	16.1	16.1	35	50	50		
3J-24Z	1.7/8"X12	1.7/8"X12	18.6	18.6	37	60	60		
3J-32Z	2.1/2"X12	2.1/2"X12	23.8	23.8	37	75	75		

1. Material options for connector

Connector material	Part. No. suffix	Part No. example
Carbon steel (Default)	Z	3J-08Z
304 stainless steel	SR	3J-08SR
316L stainless steel	SV	3J-08SV
316Ti stainless steel	SY	3J-08SY

2. Plating options and performance for carbon steel connectors.

Plating method	Part. No. suffix	Part No. example	White rust (Hours)	Red rust (Hours)
Cr3+ plating (Default)	Z	3J-08Z	96	360
Durakote plating	ZD	3J-08ZD	360	720
Zinc-nickel plating	ZN	3J-08ZN	1000	-