

26791

26792

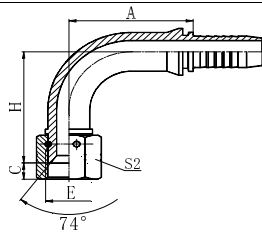

26791-W

26792-W

90° JIC FEMALE 74° CONE SEAT

REF. ISO 12151-5 / SAE J516

PART NO.		THREAD E	HOSE SIZE		DIMENSIONS			
BRAIDED	SPIRAL		DN	DASH	A	C	H	S2
26791-04-03Z	-	7/16"X20	5	03	26.5	9	23.3	14
26791-04-04Z *	-	7/16"X20	6	04	30	9	26.3	14
26791-05-04Z	-	1/2"X20	6	04	30	9.5	27	17
26791-05-05Z	-	1/2"X20	8	05	33	9.5	30	17
26791-05-06Z	-	1/2"X20	10	06	33	9.5	30	17
26791-06-04Z *	-	9/16"X18	6	04	30	10	27	19
26791-06-05Z	-	9/16"X18	8	05	33	10	30	19
26791-06-06Z *	26792-06-06Z	9/16"X18	10	06	34.5	10	31.5	19
26791-06-08Z	26792-06-08Z	9/16"X18	12	08	38	10	31.5	19
26791-08-06Z *	26792-08-06Z	3/4"X16	10	06	34.5	11	34.5	22
26791-10-08Z *	26792-10-08Z	7/8"X14	12	08	39.5	13	42	27
26791-12-08Z	26792-12-08Z	1.1/16"X12	12	08	43.5	14.5	43	32
26791-12-12Z *	26792-12-12Z *	1.1/16"X12	20	12	54.5	14.5	53.5	32
26791-12-16Z	26792-12-16Z	1.1/16"X12	25	16	65.5	14.5	53.5	32
26791-14-12Z	26792-14-12Z	1.3/16"X12	20	12	55.3	15	53.5	36
26791-16-12Z	26792-16-12Z *	1.5/16"X12	20	12	55.3	15.18	53.6	41
26791-16-16Z *	26792-16-16Z *	1.5/16"X12	25	16	71	15.18	66.1	41
26791-16-20Z	26792N-16-20Z	1.5/16"X12	32	20	81/83.6	15.18	66.12	41
26791-24-20WZ	26792N-24-20WZ	1.7/8"X12	32	20	81.5/84.1	18.6	81.5	60
26791-24-24WZ	26792N-24-24WZ	1.7/8"X12	40	24	109.4/112.4	18.6	94	60
26791-32-32WZ	26792N-32-32WZ	2.1/2"X12	50	32	133.1/137.5	23.5	121.8	75
ISO 12151-5 SHORT ELBOW (SWES)								
26791-04-04H21Z	-	7/16"X20	6	04	27.3	9	21	14
26791-05-05H21Z	-	1/2"X20	8	05	29.3	9.5	21	17
26791-06-04H23Z	-	9/16"X18	6	04	27.3	10	23	19
26791-06-06H23Z	26792-06-06H23Z	9/16"X18	10	06	31.8	10	23	19
26791-08-06H29Z	26792-08-06H29Z	3/4"X16	10	06	38.5	11	29	22
26791-08-08H29ZF	26792-08-08H29ZF	3/4"X16	12	08	47	11	29	22
26791-10-08H32Z	26792-10-08H32Z	7/8"X14	12	08	44.5	13	32	27
26791-10-10H32Z	26792-10-10H32Z	7/8"X14	16	10	49.5	13	32	27
26791-12-10Z	26792-12-10Z	1.1/16"X12	16	10	49	14.5	48	32
26791-12-12H48Z	26792-12-12H48Z	1.1/16"X12	20	12	54.3	14.5	48	32
26791-16-16H58Z	26792-16-16H58Z	1.5/16"X12	25	16	71.3	15.18	58	41
ISO 12151-5 MEDIUM ELBOW (SWEM)								
26791-04-04H32Z	-	7/16"X20	6	04	30	9	32	14
26791-05-05H32Z	-	1/2"X20	8	05	33	9.5	32	17
26791-06-06H38Z	26792-06-06H38Z	9/16"X18	10	06	34.5	10	38	19
26791-08-06H41TZ	26792-08-06H41TZ	3/4"X16	10	06	36	11	41	22
26791-08-08Z *	26792-08-08Z *	3/4"X16	12	08	39.5	11	41	22
26791-08-10Z	26792-08-10Z	3/4"X16	16	10	45.5	11	41	22
26791-10-08H47Z	26792-10-08H47Z	7/8"X14	12	08	39.5	13	47	27
26791-10-10Z *	26792-10-10Z	7/8"X14	16	10	49	13	47	27
26791-10-12Z	26792-10-12Z	7/8"X14	20	12	53.5	13	47	27
26791-12-12H58Z	26792-12-12H58Z	1.1/16"X12	20	12	54.5	14.5	58	32

26791-16-16H71Z	26792-16-16H71Z	1.5/16"X12	25	16		71	15.18	71	41
26791-20-20WZ	26792N-20-20WZ	1.5/8"X12	32	20		81.5/84.1	16.1	78	50
26791-32-32H140WZ	26792N-32-32H140WZ	2.1/2"X12	50	32		133.1/137.5	23.5	140	75
ISO 12151-5 LONG ELBOW (SWEL)									
26791-04-04H46Z	-	7/16"X20	6	04		30	9	46	14
26791-05-05H46Z	-	1/2"X20	8	05		33	9.5	46	17
26791-06-06H54Z	26792-06-06H54Z	9/16"X18	10	06		34.5	10	54	19
26791-08-08H64Z	26792-08-08H64Z	3/4"X16	12	08		39.5	11	64	22
26791-10-10H70Z	26792-10-10H70Z	7/8"X14	16	10		49	13	70	27
26791-12-10H96Z	26792-12-10H96Z	1.1/16"X12	16	10		49	14.5	96	32
26791-12-12H96Z	26792-12-12H96Z	1.1/16"X12	20	12		54.5	14.5	96	32
26791-16-16H114Z	26792-16-16H114Z	1.5/16"X12	25	16		76.7	15.18	114	41
26791-20-20H129WZ	26792N-20-20H129WZ	1.5/8"X12	32	20		81.5/84.1	16.1	129	50
26791-24-24H141WZ	26792N-24-24H141WZ	1.7/8"X12	40	24		109.4/112.4	18.6	141	60
26791-32-32H222WZ	26792N-32-32H222WZ	2.1/2"X12	50	32		133.1/137.5	23.5	222	75

1. The dimension A before "/" is for braided hose fitting and after "/" is for spiral hose fitting.

2. Part no. marked with "*" is recommended.

3. Material options for fitting.

Fitting material	Part. No. suffix	Part No. example
Carbon steel (Default)	Z/TZ/WZ	26791-08-08Z
304 stainless steel	SR/SRT/SRW	26791-08-08SR
316L stainless steel	SV/SVT/SVW	26791-08-08SV
316Ti stainless steel	SY/SYT/SYW	26791-08-08SY

4. Plating options and performance for carbon steel fittings.

Plating method	Part. No. suffix	Part No. example	White rust (Hours)	Red rust (Hours)
Cr3+ plating (Default)	Z	26791-08-08Z	96	360
Durakote plating	ZD	26791-08-08ZD	360	720
Zinc-nickel plating	ZN	26791-08-08ZN	1000	-