

22611-OR  
22612-OR

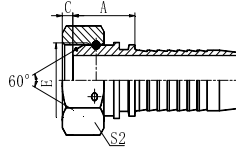

22611-ORW  
22612-ORW

BSP FEMALE 60° CONE

REF. ISO 12151-6

PART NO.		THREAD E	HOSE SIZE		O-RING	DIMENSIONS			
BRAIDED	SPIRAL		DN	DASH		A	C	S2	
22611-04-04ORZ *	-	G1/4"X19	6	04	O06.1X1.0	18	5.5	19	
22611-06-05ORZ	-	G3/8"X19	8	05	O08.1X1.6	19	6.3	22	
22611-06-06ORZ *	22612-06-06ORZ	G3/8"X19	10	06	O08.1X1.6	19.5	6.3	22	
22611-08-08ORZ *	22612-08-08ORZ *	G1/2"X14	12	08	O12.1X1.6	21.5	7.5	27	
22611-10-10ORZ	22612-10-10ORZ	G5/8"X14	16	10	O13.1X1.6	23	9.5	30	
22611-12-12ORZ *	22612-12-12ORZ *	G3/4"X14	20	12	O17.1X1.6	24	10.9	32	
22611-16-16ORZ *	22612-16-16ORZ *	G1"X11	25	16	O22.1X1.6	27	11.7	41	
22611-20-20ORWZ *	22612N-20-20ORWZ	G1.1/4"X11	32	20	O29.1X1.6	30.5/33.1	10.1	50	
22611-24-24ORWZ *	22612N-24-24ORWZ	G1.1/2"X11	40	24	O35.1X1.6	32/25	12.5	55	
22611-32-32ORWZ *	22612N-32-32ORWZ	G2"X11	50	32	O47.37X1.78	31/35.4	16.1	70	

1. The dimension A before"/" is for braided hose fitting and after "/" is for spiral hose fitting.
2. Part no. marked with "\*" is recommended.
3. Material options for fitting and the O-ring.

Fitting material	O-ring material	Part. No. suffix	Part No. example
Carbon steel (Default)	NBR	Z/WZ	22611-08-08ORZ
304 stainless steel	Viton	SR/SRW	22611-08-08ORSR
316L stainless steel	Viton	SV/SVW	22611-08-08ORSV
316Ti stainless steel	Viton	SY/SYW	22611-08-08ORSY

4. Plating options and performance for carbon steel fittings.

Plating method	Part. No. suffix	Part No. example	White rust (Hours)	Red rus (Hours)
Cr3+ plating (Default)	Z	22611-08-08ORZ	96	360
Durakote plating	ZD	22611-08-08ORZD	360	720
Zinc-nickel plating	ZN	22611-08-08ORZN	1000	-