

20591C-T  
20592C-T

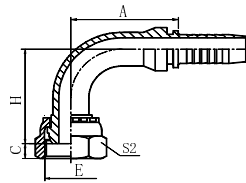

20591C  
20592C

90° METRIC FEMALE 24° MULTISEAL S SERIES

| PART NO.         |                 | THREAD E | HOSE SIZE |      | TUBE O.D. | DIMENSIONS |     |      |    |
|------------------|-----------------|----------|-----------|------|-----------|------------|-----|------|----|
| BRAIDED          | SPIRAL          |          | DN        | DASH |           | A          | C   | H    | S2 |
| 20591C-16-04TZ   | -               | M16X1.5  | 6         | 04   | 8         | 30         | 3.5 | 32.5 | 19 |
| 20591C-18-04TZ * | -               | M18X1.5  | 6         | 04   | 10        | 30         | 3   | 30.5 | 22 |
| 20591C-20-05TZ   | -               | M20X1.5  | 8         | 05   | 12        | 33         | 4.5 | 34   | 24 |
| 20591C-20-06TZ   | 20592C-20-06TZ  | M20X1.5  | 10        | 06   | 12        | 34.5       | 4.5 | 35.5 | 24 |
| 20591C-22-06TZ * | 20592C-22-06TZ  | M22X1.5  | 10        | 06   | 14        | 34.5       | 4.5 | 36   | 27 |
| 20591C-24-08TZ * | 20592C-24-08TZ  | M24X1.5  | 12        | 08   | 16        | 39.5       | 5   | 43.5 | 30 |
| 20591C-30-10TZ   | 20592C-30-10TZ  | M30X2    | 16        | 10   | 20        | 49         | 7   | 50.5 | 36 |
| 20591C-36-12TZ   | 20592C-36-12TZ  | M36X2    | 20        | 12   | 25        | 56         | 6.5 | 55.5 | 41 |
| 20591C-42-16TZ   | 20592C-42-16TZ  | M42X2    | 25        | 16   | 30        | 71         | 9   | 68.4 | 50 |
| 20591C-52-20TZ   | 20592CN-52-20TZ | M52X2    | 32        | 20   | 38        | 83/85.6    | 8   | 81.5 | 60 |

- The dimension A before "/" is for braided hose fitting and after "/" is for spiral hose fitting.
- Part no. marked with "\*" is recommended.
- Material options for fitting.

| Fitting material       | Part. No. suffix | Part No. example |
|------------------------|------------------|------------------|
| Carbon steel (Default) | TZ               | 20591C-24-08TZ   |
| 304 stainless steel    | SRT              | 20591C-24-08SRT  |
| 316L stainless steel   | SVT              | 20591C-24-08SVT  |
| 316Ti stainless steel  | SYT              | 20591C-24-08SYT  |

- Plating options and performance for carbon steel fittings.

| Plating method         | Part. No. suffix | Part No. example | White rust (Hours) | Red rust (Hours) |
|------------------------|------------------|------------------|--------------------|------------------|
| Cr3+ plating (Default) | Z                | 20591C-24-08TZ   | 96                 | 360              |
| Durakote plating       | ZD               | 20591C-24-08TZD  | 360                | 720              |
| Zinc-nickel plating    | ZN               | 20591C-24-08TZN  | 1000               | -                |