

20491C-T  
20492C-T

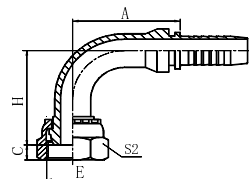

20491C  
20492C

90° METRIC FEMALE 24° MULTISEAL L SERIES

PART NO.		THREAD E	HOSE SIZE		TUBE O.D.	DIMENSIONS			
BRAIDED	SPIRAL		DN	DASH		A	C	H	S2
20491C-14-04Z *	-	M14X1.5	6	04	8	30	3.5	28.5	19
20491C-16-04TZ	-	M16X1.5	6	04	10	30	4	32	19
20491C-16-05Z *	-	M16X1.5	8	05	10	33	3.5	32	22
20491C-16-06Z	20492C-16-06Z	M16X1.5	10	06	10	35	3.5	32	22
20491C-18-06TZ *	20492C-18-06TZ	M18X1.5	10	06	12	37	3	35	22
20491C-22-08TZ	20492C-22-08TZ	M22X1.5	12	08	15	42	4.5	42	27
20491C-26-10TZ	20492C-26-10TZ	M26X1.5	16	10	18	51.2	4	51.5	32
20491C-30-12TZ	20492C-30-12TZ	M30X2	20	12	22	57	7	55.5	36
20491C-36-12TZ	20492C-36-12TZ	M36X2	20	12	28	55.3	6.5	55.5	41

1. Part no. marked with "\*" is recommended.

2. Material options for fitting.

Fitting material	Part. No. suffix	Part No. example
Carbon steel (Default)	Z/TZ	20491C-22-08TZ
304 stainless steel	SR/SRT	20491C-22-08SRT
316L stainless steel	SV/SVT	20491C-22-08SVT
316Ti stainless steel	SY/SYT	20491C-22-08SYT

3. Plating options and performance for carbon steel fittings.

Plating method	Part. No. suffix	Part No. example	White rust (Hours)	Red rust (Hours)
Cr3+ plating (Default)	Z	20491C-22-08TZ	96	360
Durakote plating	ZD	20491C-22-08TZD	360	720
Zinc-nickel plating	ZN	20491C-22-08TZZN	1000	-