

20141  
20142

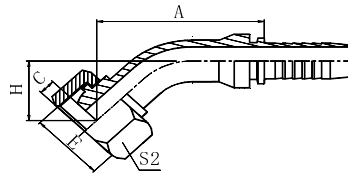

20141-T  
20142-T

45° METRIC FEMALE MULTISEAL

PART NO.		THREAD E	HOSE SIZE		DIMENSIONS			
BRAIDED	SPIRAL		DN	DASH	A	C	H	S2
20141-10-03Z	-	M10X1	5	03	41.1	2.5	20.7	14
20141-10-04Z	-	M10X1	6	04	43.2	2.5	21.5	14
20141-12-03Z	-	M12X1.5	5	03	40.9	4	21.2	17
20141-12-04Z	-	M12X1.5	6	04	43	4	20.9	17
20141-14-04Z *	-	M14X1.5	6	04	43.4	4.5	21.3	19
20141-14-05Z	-	M14X1.5	8	05	45.5	4.5	22.2	19
20141-16-04Z	-	M16X1.5	6	04	43.7	4.5	21.6	22
20141-16-05Z *	-	M16X1.5	8	05	45.8	4.5	22.5	22
20141-16-06Z	20142-16-06Z	M16X1.5	10	06	47.4	4.5	23.2	22
20141-18-05TZ	-	M18X1.5	8	05	46.8	4	22.6	24
20141-18-06Z *	20142-18-06Z	M18X1.5	10	06	48.5	4	24.2	24
20141-18-08Z	20142-18-08Z	M18X1.5	12	08	52.2	4	25.7	24
20141-20-06TZ	20142-20-06TZ	M20X1.5	10	06	47.4	5.5	23.2	24
20141-20-08Z	20142-20-08Z	M20X1.5	12	08	45	5.5	18.3	27
20141-22-06TZ	20142-22-06TZ	M22X1.5	10	06	47.8	5	23.5	27
20141-22-08Z *	20142-22-08Z	M22X1.5	12	08	62.5	5	27.5	27
20141-24-08TZ	20142-24-08TZ	M24X1.5	12	08	61.1	5.5	26.1	30
20141-24-10Z	20142-24-10Z	M24X1.5	16	10	75.4	5	29.6	30
20141-27-10DTZ	20142-27-10DTZ	M27X1.5	16	10	72.1	5.5	27.8	32
20141-27-10TZ	20142-27-10TZ	M27X2	16	10	72.1	5.5	27.8	32
20141-30-12DZ	20142-30-12DZ	M30X1.5	20	12	81.7	6	33.6	36
20141-30-12Z	20142-30-12Z	M30X2	20	12	81.7	6	33.6	36
20141-39-16TZ	20142-39-16TZ	M39X2	25	16	89.5	7	34	46
20141-45-20TZ	20142N-45-20TZ	M45X2	32	20	99.1/101.7	8.5	38.4	55
20141-52-24TZ	20142N-52-24TZ	M52X2	40	24	114.1/117.1	9	43.4	60

1. The dimension A before "/" is for braided hose fitting and after "/" is for spiral hose fitting.
2. Part no. marked with "\*" is recommended.
3. Material options for fitting.

Fitting material	Part. No. suffix	Part No. example
Carbon steel (Default)	Z/TZ	20141-18-06Z
304 stainless steel	SR/SRT	20141-18-06SR
316L stainless steel	SV/SVT	20141-18-06SV
316Ti stainless steel	SY/SYT	20141-18-06SY

4. Plating options and performance for carbon steel fittings.

Plating method	Part. No. suffix	Part No. example	White rust (Hours)	Red rust (Hours)
Cr3+ plating (Default)	Z	20141-18-06Z	96	360
Durakote plating	ZD	20141-18-06ZD	360	720
Zinc-nickel plating	ZN	20141-18-06ZN	1000	-