

# ADAPTER

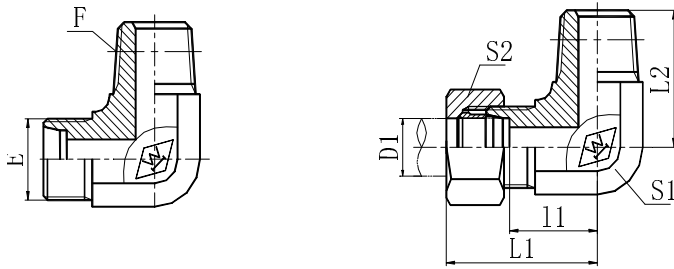

90° METRIC MALE 24° CONE / NPT MALE

**1CN9**

**1CN9-RNW**

**1DN9**

**1DN9-RNW**

PART NO.		THREAD		D1 TUBE O.D.	DIMENSIONS				
BODY	ASSEMBLY	E	F		l1	L1	L2	S1	S2
L SERIES									
1CN9-12-02Z	1CN9-12-02RNWZ	M12X1.5	Z1/8"X27	6	13	28	21	11	14
1CN9-12-04Z	1CN9-12-04RNWZ	M12X1.5	Z1/4"X18	6	15.5	30.5	25.5	14	14
1CN9-14-02Z	1CN9-14-02RNWZ	M14X1.5	Z1/8"X27	8	15.5	31.5	21	14	17
1CN9-14-04Z	1CN9-14-04RNWZ	M14X1.5	Z1/4"X18	8	15.5	31.5	25.5	14	17
1CN9-14-06Z	1CN9-14-06RNWZ	M14X1.5	Z3/8"X18	8	18	34	31	19	17
1CN9-16-02Z	1CN9-16-02RNWZ	M16X1.5	Z1/8"X27	10	17.5	33.5	25	16	19
1CN9-16-04Z	1CN9-16-04RNWZ	M16X1.5	Z1/4"X18	10	17.8	33.8	27	16	19
1CN9-16-06Z	1CN9-16-06RNWZ	M16X1.5	Z3/8"X18	10	19	35	28	19	19
1CN9-18-04Z	1CN9-18-04RNWZ	M18X1.5	Z1/4"X18	12	19	35	28	19	22
1CN9-18-06Z	1CN9-18-06RNWZ	M18X1.5	Z3/8"X18	12	19	35	28	19	22
1CN9-18-08Z	1CN9-18-08RNWZ	M18X1.5	Z1/2"X14	12	21	37	36.5	22	22
1CN9-22-06Z	1CN9-22-06RNWZ	M22X1.5	Z3/8"X18	15	22	38	32.5	22	27
1CN9-22-08Z	1CN9-22-08RNWZ	M22X1.5	Z1/2"X14	15	22	38	36.5	22	27
1CN9-22-12Z	1CN9-22-12RNWZ	M22X1.5	Z3/4"X14	15	25.5	41.5	44	27	27
1CN9-26-06Z	1CN9-26-06RNWZ	M26X1.5	Z3/8"X18	18	25.5	42	33.5	27	32
1CN9-26-08Z	1CN9-26-08RNWZ	M26X1.5	Z1/2"X14	18	25.5	42	40	27	32
1CN9-26-12Z	1CN9-26-12RNWZ	M26X1.5	Z3/4"X14	18	25.5	42	44	27	32
1CN9-30-08Z	1CN9-30-08RNWZ	M30X2	Z1/2"X14	22	29.3	45.8	41	30	36
1CN9-30-12Z	1CN9-30-12RNWZ	M30X2	Z3/4"X14	22	29.3	45.8	45	30	36
1CN9-30-16Z	1CN9-30-16RNWZ	M30X2	Z1"X11.5	22	32	48.5	50	33	36
1CN9-36-12Z	1CN9-36-12RNWZ	M36X2	Z3/4"X14	28	33	49.5	49	36	41
1CN9-36-16Z	1CN9-36-16RNWZ	M36X2	Z1"X11.5	28	33	49.5	51.5	36	41
1CN9-45-16Z	1CN9-45-16RNWZ	M45X2	Z1"X11.5	35	39	60.5	58.5	48	50
1CN9-45-20Z	1CN9-45-20RNWZ	M45X2	Z1.1/4"X11.5	35	39.5	60.5	58.5	48	50
1CN9-52-20Z	1CN9-52-20RNWZ	M52X2	Z1.1/4"X11.5	42	40.5	63.5	60.5	50	60
1CN9-52-24Z	1CN9-52-24RNWZ	M52X2	Z1.1/2"X11.5	42	40.5	63.5	61	50	60
1CN9-52-32Z	1CN9-52-32RNWZ	M52X2	Z2"X11.5	42	46	69	64.9	63	60
S SERIES									
1DN9-14-04Z	1DN9-14-04RNWZ	M14X1.5	Z1/4"X18	6	17.5	32.5	25.5	14	17
1DN9-16-04Z	1DN9-16-04RNWZ	M16X1.5	Z1/4"X18	8	18.5	33.5	26.5	16	19
1DN9-16-06Z	1DN9-16-06RNWZ	M16X1.5	Z3/8"X18	8	20	36	28	19	19
1DN9-18-04Z	1DN9-18-04RNWZ	M18X1.5	Z1/4"X18	10	19.5	36	27.5	19	22

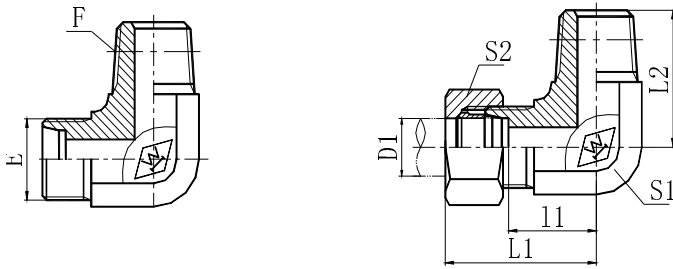

90° METRIC MALE 24° CONE / NPT MALE

**1CN9**

**1CN9-RNW**

**1DN9**

**1DN9-RNW**

1DN9-18-06Z	1DN9-18-06RNWZ	M18X1.5	Z3/8"X18	10	19.5	36	28	19	22
1DN9-20-04Z	1DN9-20-04RNWZ	M20X1.5	Z1/4"X18	12	19.5	36	28	19	24
1DN9-20-06Z	1DN9-20-06RNWZ	M20X1.5	Z3/8"X18	12	19.5	36	28	19	24
1DN9-20-08Z	1DN9-20-08RNWZ	M20X1.5	Z1/2"X14	12	21.5	38	34.8	22	24
1DN9-20-12Z	1DN9-20-12RNWZ	M20X1.5	Z3/4"X14	12	24.5	41	38.3	27	24
1DN9-22-06Z	1DN9-22-06RNWZ	M22X1.5	Z3/8"X18	14	23	41	30	22	27
1DN9-22-08Z	1DN9-22-08RNWZ	M22X1.5	Z1/2"X14	14	23	41	36.5	22	27
1DN9-24-06Z	1DN9-24-06RNWZ	M24X1.5	Z3/8"X18	16	24	42.5	31	24	30
1DN9-24-08Z	1DN9-24-08RNWZ	M24X1.5	Z1/2"X14	16	24	42.5	37.5	24	30
1DN9-24-12Z	1DN9-24-12RNWZ	M24X1.5	Z3/4"X14	16	33	51.5	38.3	27	30
1DN9-30-08Z	1DN9-30-08RNWZ	M30X2	Z1/2"X14	20	28	48.5	41	30	36
1DN9-30-12Z	1DN9-30-12RNWZ	M30X2	Z3/4"X14	20	28	48.5	45	30	36
1DN9-36-12Z	1DN9-36-12RNWZ	M36X2	Z3/4"X14	25	32.5	55.5	49	36	46
1DN9-36-16Z	1DN9-36-16RNWZ	M36X2	Z1"X11.5	25	32.5	55.5	51.5	36	46
1DN9-42-16Z	1DN9-42-16RNWZ	M42X2	Z1"X11.5	30	36	62.5	54.5	41	50
1DN9-42-20Z	1DN9-42-20RNWZ	M42X2	Z1.1/4"X11.5	30	36	62.5	54.5	41	50
1DN9-52-20Z	1DN9-52-20RNWZ	M52X2	Z1.1/4"X11.5	38	41	72	60.5	50	60
1DN9-52-24Z	1DN9-52-24RNWZ	M52X2	Z1.1/2"X11.5	38	41.5	72.5	61	50	60

1. Material options for connector body and nut.

Connector body and nut material	Part. No. suffix	Part No. example
Carbon steel (Default)	Z	1CN9-36-16Z
304 stainless steel	SR	1CN9-36-16SR
316L stainless steel	SV	1CN9-36-16SV
316Ti stainless steel	SY	1CN9-36-16SY

2. Plating options and performance for carbon steel connectors.

Plating method	Part. No. suffix	Part No. example	White rust (Hours)	Red rust (Hours)
Cr3+ plating (Default)	Z	1CN9-36-16Z	96	360
Durakote plating	ZD	1CN9-36-16ZD	360	720
Zinc-nickel plating	ZN	1CN9-36-16ZN	1000	-